



Caregiver Tips

For Liquid Roxanol™

(Illustrations located on page 2)

When patients are on **HOPE Healthcare and Hospice** services, we prioritize managing their symptoms and keeping them comfortable. One of the many ways to manage pain and shortness of breath throughout a patient's illness or at the end of life is with a medication known as Roxanol.

Roxanol plays an essential role in decreasing the patient's fear and anxiety by dilating the bronchioles in the lungs, increasing the patient's oxygen capacity, and breathing more easily.

Roxanol is a short-acting medication that can be swallowed or placed under the tongue or inside the cheek. It will take effect approximately 15 minutes after administering it and should be taken with food or beverages. The **HOPE Healthcare and Hospice** team will work with you and/or your family to manage all of your comfort needs.

Side Effects may include:

- Constipation: Ample intake of water or other liquids is encouraged. Stool softeners are encouraged to prevent constipation. Please contact your nurse if you have not had a bowel movement in 2-3 days.
- Nausea, Vomiting, and/or Stomach Pain can occur at the start of Roxanol. However, it should diminish in 1-2 days. If symptoms continue for more than one week, notify your hospice nurse.
- Dizziness or lightheadedness: Sit or lie down if you feel dizzy or lightheaded and remember to get up slowly from both positions.
- Drowsiness can occur when a patient begins taking Roxanol™, but this side effect should go away within a few days. If symptoms continue or you feel too groggy or sleepy, contact your hospice nurse to adjust your dosage.
- Dry Mouth is very common and may be persistent. Good oral hygiene can help, as well as saliva stimulants or artificial saliva replacement. Popsicles, hard candy, and mints are often helpful.



The HOPE Healthcare and Hospice Team
is available to answer your questions and provide comfort care and support during this time.

(337) 703 - 4674

Caregiver tips for LIQUID ROXANOL™

Filling a Syringe from the Roxanol Bottle

Illustration A

DOSAGE FORMS & STRENGTHS			
5MG	10MG	15MG	20MG
0.25ML	0.5ML	0.75ML	1.0ML

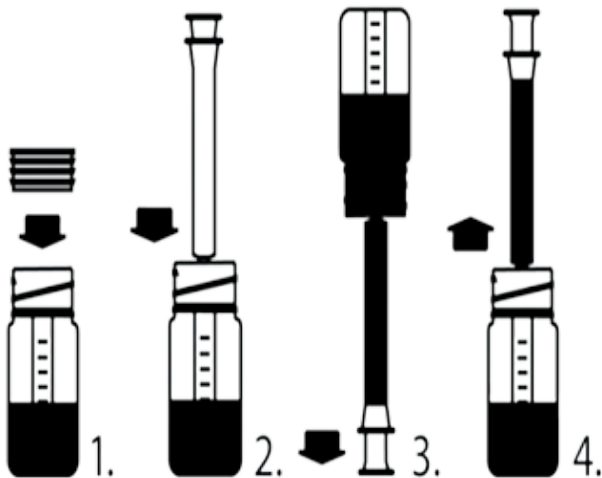

Illustration B

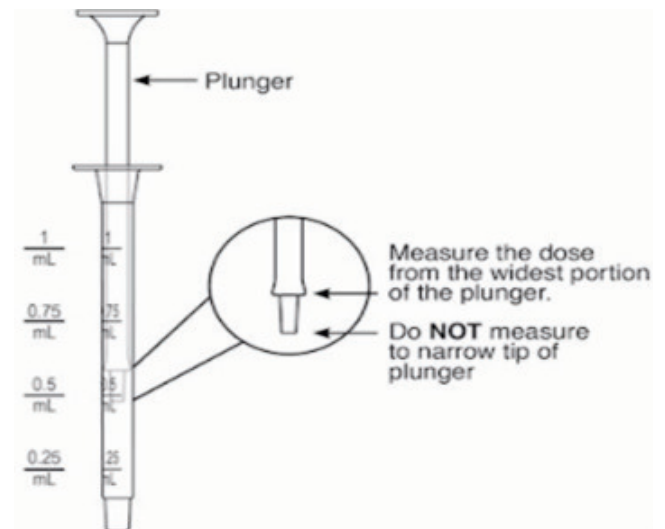

Illustration C

Do you have additional questions or concerns about Administering Medication?

Call our hospice nurse at (337) 703-4674